

SURFACE PROTECT./OBERFL. SCHUTZ	
I	JED-240-3
II	JED-256-1
III	JED-371
IV	RUBBER/PLASTIC
V	MS
VI	JED-240-2

SERVICE PRESSURE : Pe max. = 10.2bar
 BETRIEBSDRUCK :
 PRESSION DE SERVICE :
 PRESSIONE DI ESERCIZIO :
 (TEMPORARILY) : Pe max. = 13 bar
 (KURZZEITIG) :
 (DE COURTE DUREE) :
 (BREVE TEMPO SOLO) :

FORCE OF RETURN SPRING : 250 ± 25 N
 RUECKSTELLKRAFT DER FEDER :
 EFFORT DURESSORTDE RAPPEL :
 FORZA DELLA MOLLA RITORNO :

THERMAL RANGE OF APPLICATION : -40° C. + 80° C
 THERMISCHER ANWENDUNGSBEREICH :
 GAMME D'APPLICATION THERMIQUE :
 CAMPO DI APPLICAZIONE TERMICA :

MEDIUM : AIR
 MEDIUM : LUFT
 FLUIDE : AIR
 FLUIDO : ARIA

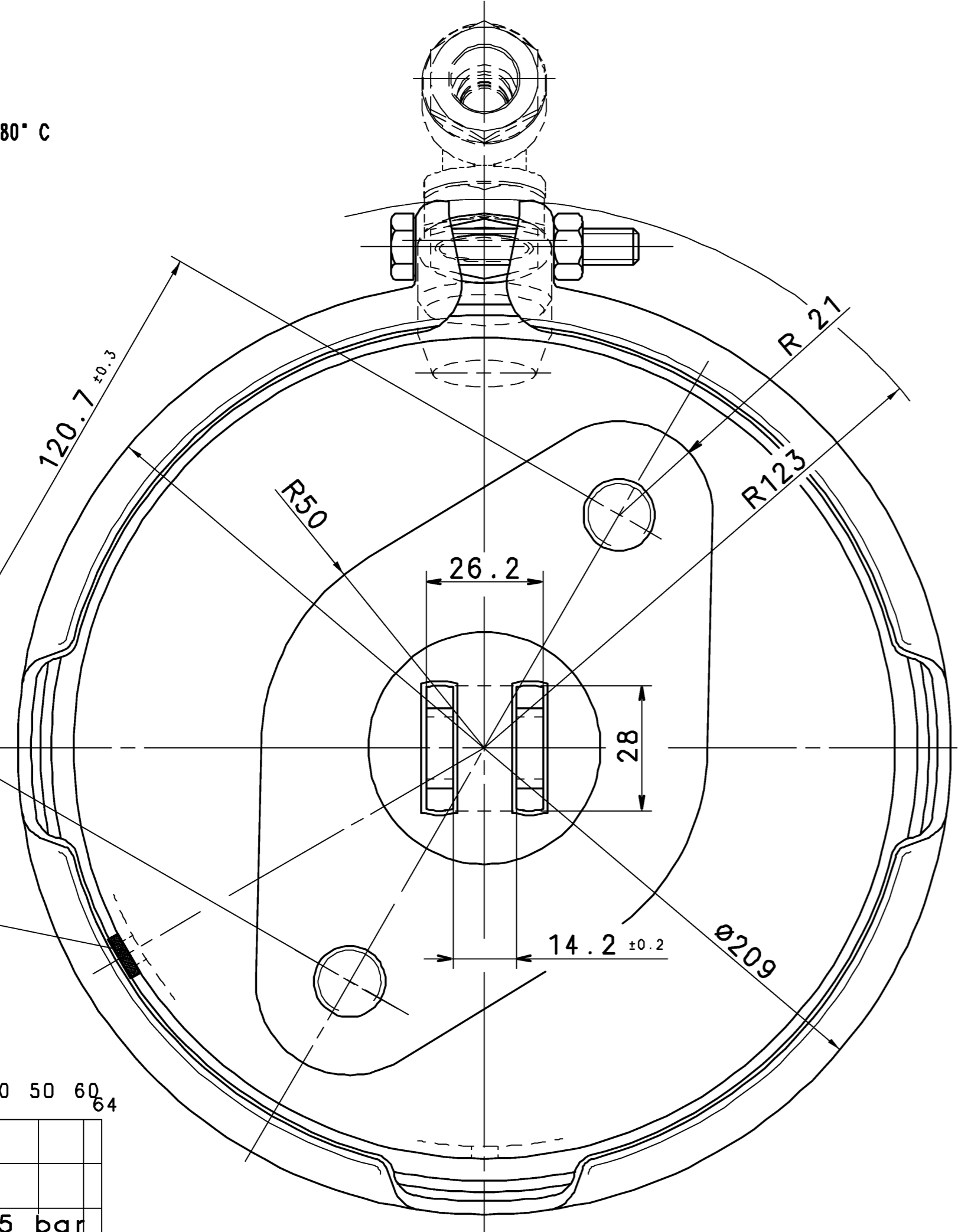
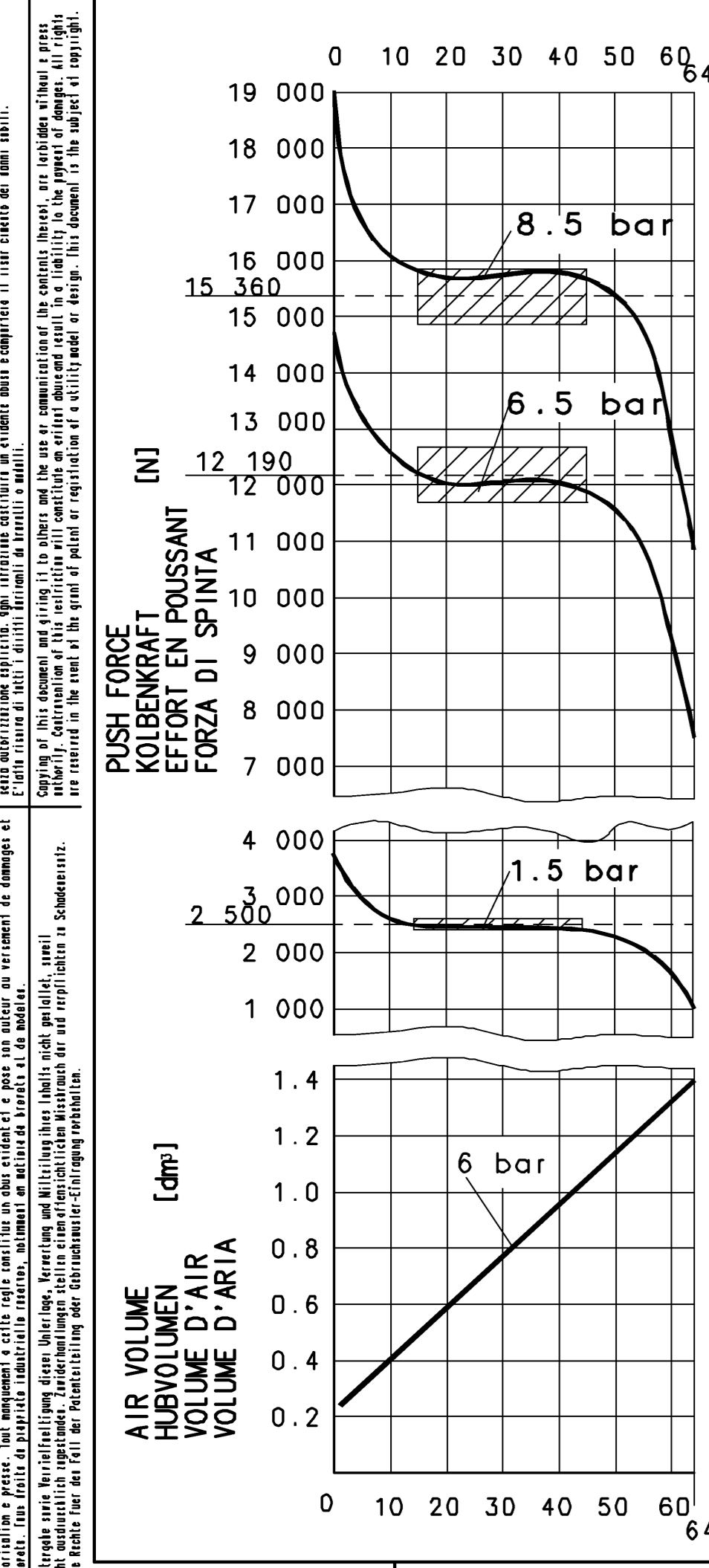

TO BE INSTALLED WITH LOWER BREATHER HOLE OPEN
 IM EINBAUZUSTAND UNTERE ATMUNGSBOHRUNG OFFEN
 A MONTER AVEC LE RENIFLARD INFERIEUR OUVERT
 INSTALLAZIONE : CON IL FORO DI SFIATO INFERIORE APERTO

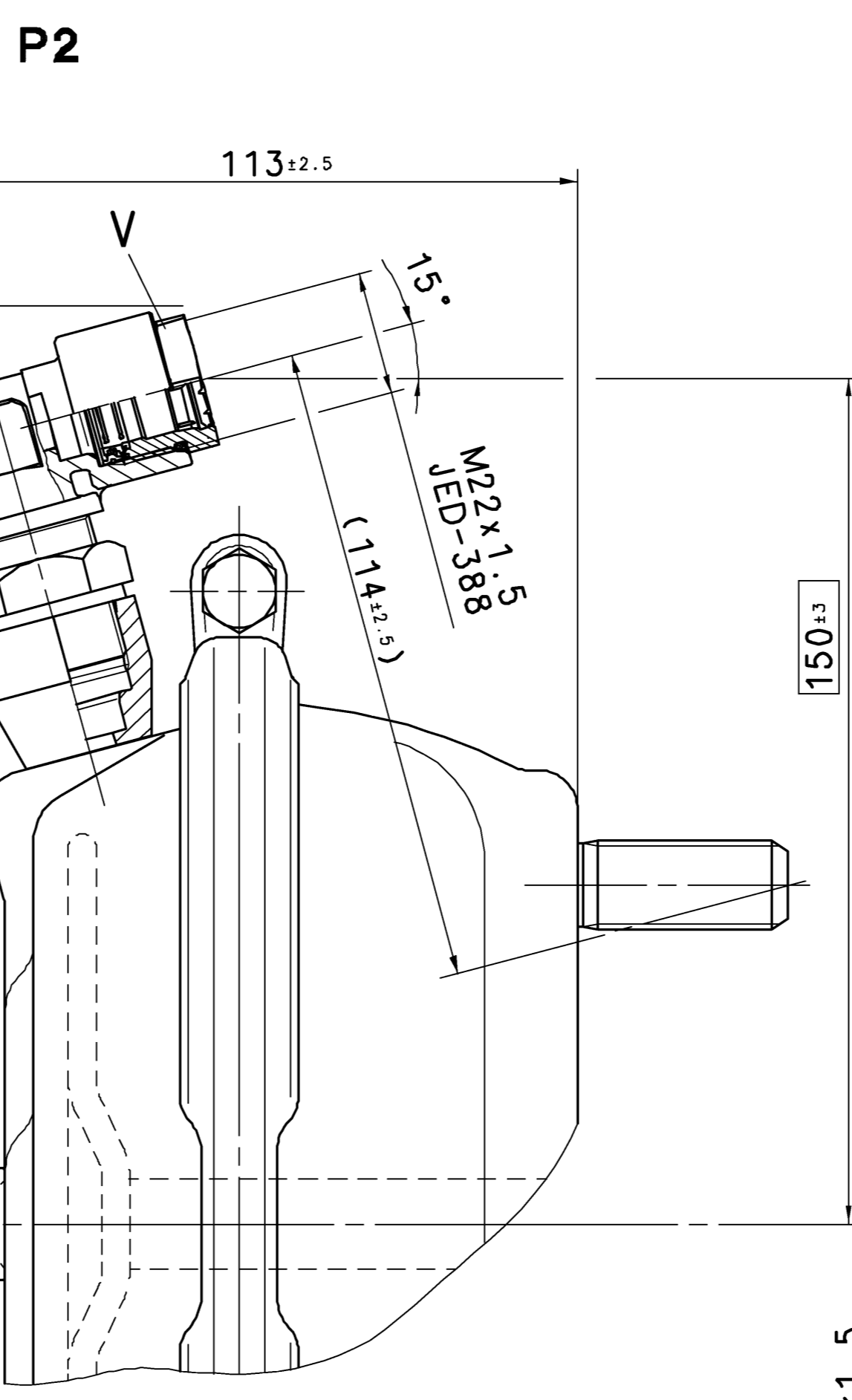
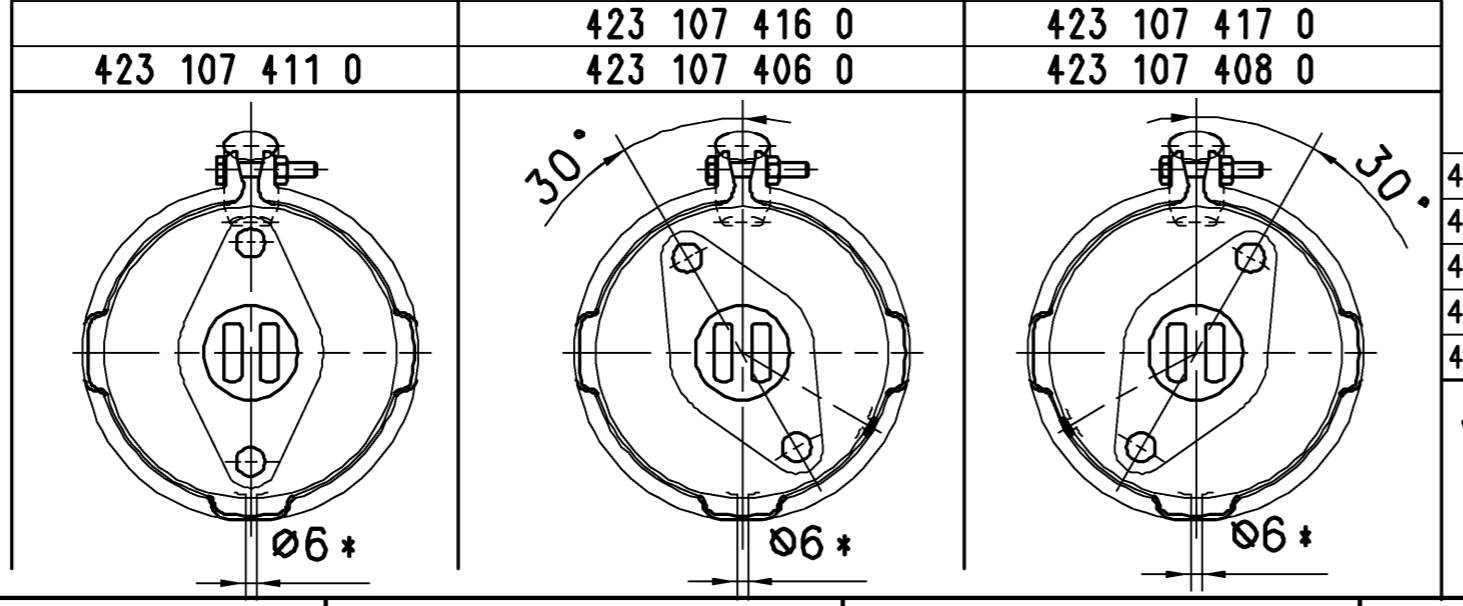
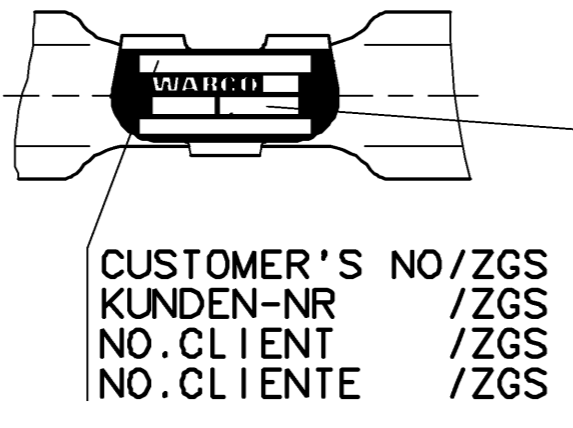

THEORETICAL SWIVEL POINT OF THE PUSH ROD
 THEOR. SCHWENKPUNKT DER DRUCKSTANGE
 CENTRE D'ARTICULATION THEORIQUE DE LA TIGE
 CENTRO D'ARTICOLAZIONE TEORICO DELL'ASTA

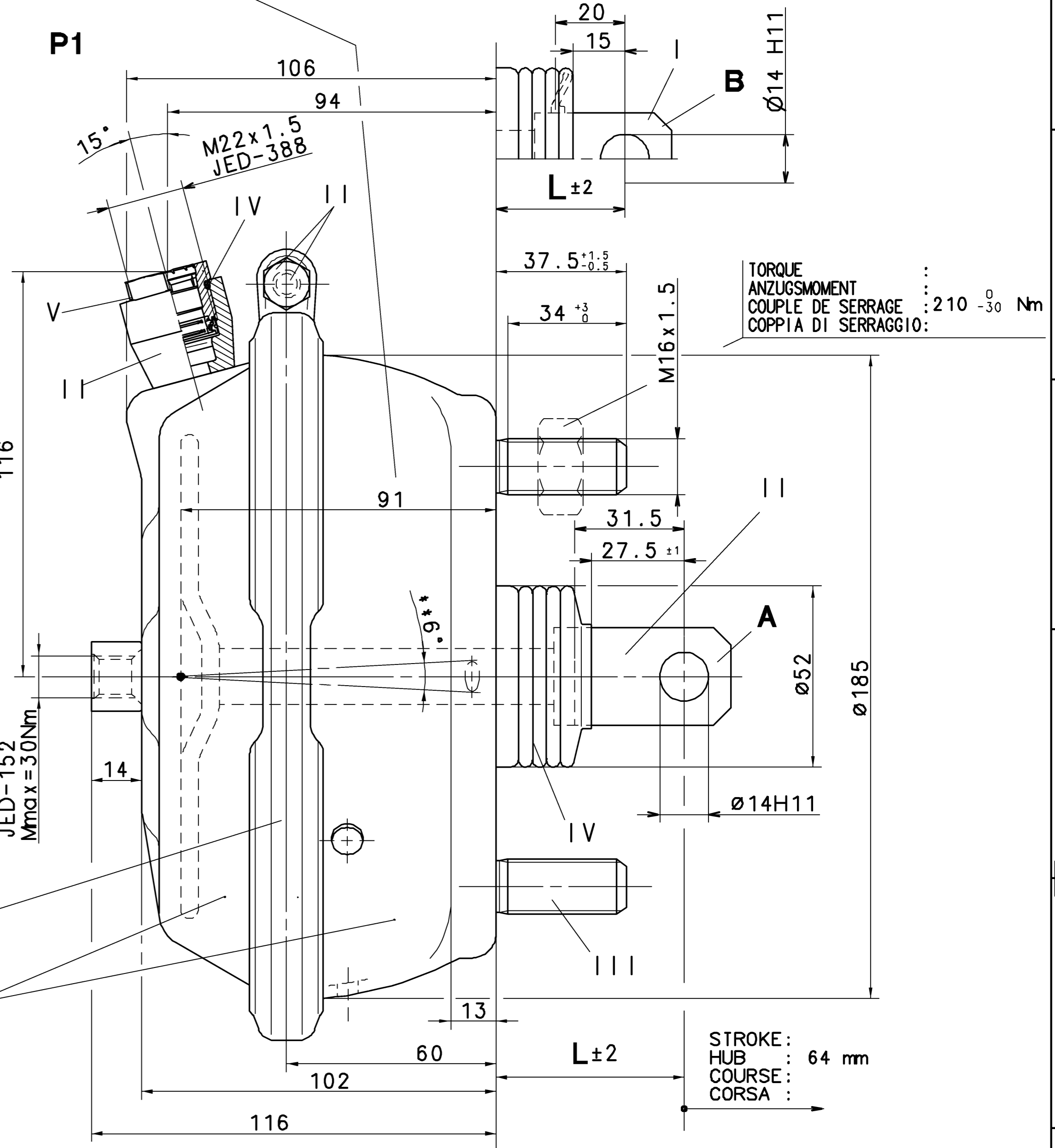

TORQUE ANZUGSMOMENT : 210 ± 30 Nm
 COUPLE DE SERRAGE :
 COPPIA DI SERRAGGIO :

ADMISSIBLE INSTALLATION POSITION
 ZULAESSIGE EINBAUPLAGE
 POSITION D'INSTALLATION ADMISE
 POSIZIONE DI MONTAGGIO AMMESSA

- **) DEFLECTION : max. 6° AT STROKE
 AUSLENKUNG : BEI HUB 0 mm
 DEFLEXION : A COURSE
 DEVIAZIONE : A CORSA
- *) OPEN BREATHER HOLE
 OFFEN ATMUNGSBOHRUNG
 OUVERT TROU DE RENIFLANT
 APERTO FORO RESPIRATORE

MAIN VIEWS REFER TO DIMENSIONS ONLY
 HAUPTANSICHTEN BEZIEHEN SICH NUR AUF DIE ABMESSUNGEN
 VUES PRINCIPALES CONCERNENT LES DIMENSIONS SEULEMENT
 VISITE PRINCIPALI RIGUARDANO DIMENSIONI SOLAMENTE

POSITION OF COMPONENTS SEE REPRESENTATION OF VARIATIONS
 POSITION DER BAUTEILE SIEHE ABWANDLUNGSDARSTELLUNGEN
 POSITION DES COMPOSANTS VOIR DESSIN DE LA VARIANTE
 POSIZIONE DELLE COMPONENTI VERDERE DISEGNO DI VARIANTE

423 107 417 0	423 107 416 0	423 107 417 0	423 107 411 0	423 107 406 0	423 107 408 0
A 007 420 95 24	A 007 420 94 24	A 007 420 93 24	A 007 420 92 24	A 007 420 91 24	A 007 420 91 24
re.	li.	re.	li.	li.	li.
37	37	37	54	54	54
P1	P2	P1	P1	P1	P1
B	B	B	A	A	A
Z	Y	X	X	X	X
3.6	3.6	3.6	3.6	3.6	3.6
WABCO	CUSTOMER'S NO. / KUNDEN-NR. / NO. CLIENT. / NO. CLIENTE.	ZGS	L	CAD	PORT ANSCHLUSS / ORIFICE / ORIFICIO
					YOKO GABELKOPF / CHAPE / FORCELLA
					NAME PLATE / BEZEICHNUNGSSCHILD / PLAQUE DE FIRME / TARGETTA
					WEIGHT / GEWICHT / POIDS / PESO
					kg

General Specification: JED-334-0	Copyright WABCO	WABCO	30
Further Technical Data:	Date: 08-05-16	Drawn: Medynski	Sheet: 1/1
Doc. Code: 08-05-16	Sheet: Szuberski	Checked: Szuberski	Material No. 423 107 409 0
General Tolerances JED-261	Class 11	Class 12	Class 13
Range of Nominal Dimensions (± mm)	< 50	50 > 180	180 > 400
Fine	0.5	1.0	1.5
Medium	1.0	2.0	3.0
Coarse	2.0	3.5	5.0
Tapped Holes acc. JED-152 / JED-388	11 Tolerance Class Applied Crossmarked	A 1	CCD
ECH-No. 117275	Revision 1xQ	Techn. Resp. 5340	Replacement for